

## PILASTER UPRIGHT DRAWER BOX TEMPLATE - RIGHT SIDE CABINET WALL

### SIDE VIEW OF SLIDE

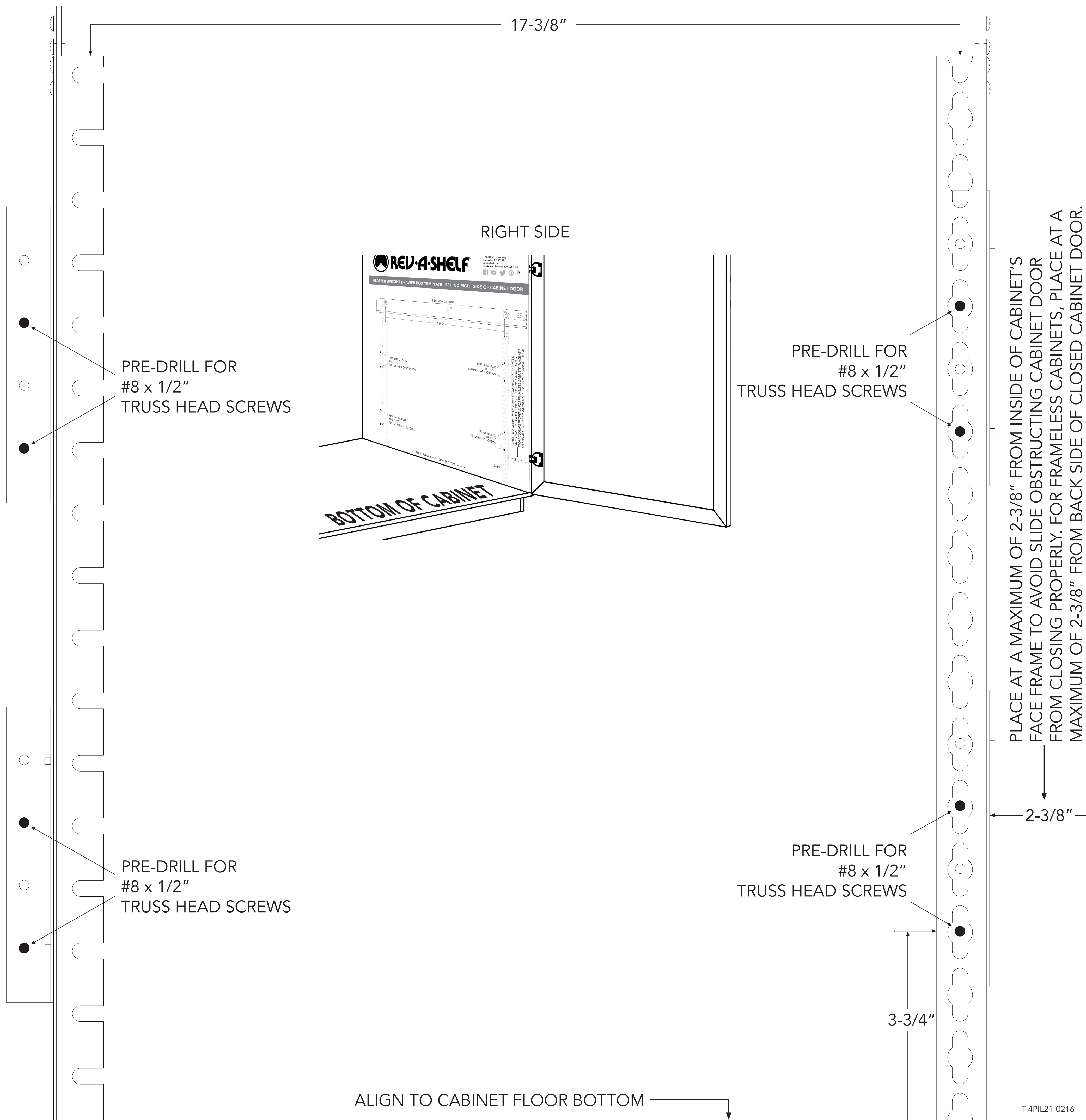
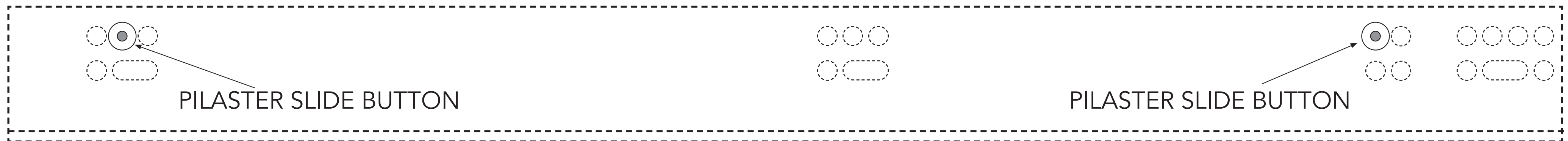

## PILASTER UPRIGHT DRAWER BOX TEMPLATE - LEFT SIDE CABINET WALL

SIDE VIEW OF SLIDE

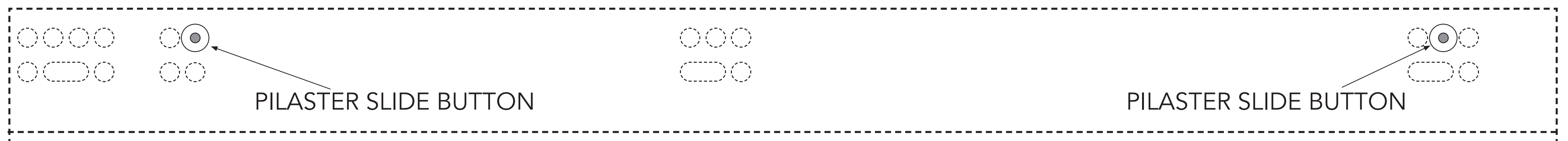

PLACE AT A MAXIMUM OF 2-3/8" FROM INSIDE OF CABINET'S FACE FRAME TO AVOID SLIDE OBSTRUCTING CABINET DOOR FROM CLOSING PROPERLY. FOR FRAMELESS CABINETS, PLACE AT A MAXIMUM OF 2-3/8" FROM BACK SIDE OF CLOSED CABINET DOOR.

2-3/8"

PRE-DRILL FOR #8 x 1/2" TRUSS HEAD SCREWS

PRE-DRILL FOR #8 x 1/2" TRUSS HEAD SCREWS

3-3/4"

17-3/8"

LEFT SIDE

PRE-DRILL FOR #8 x 1/2" TRUSS HEAD SCREWS

PRE-DRILL FOR #8 x 1/2" TRUSS HEAD SCREWS

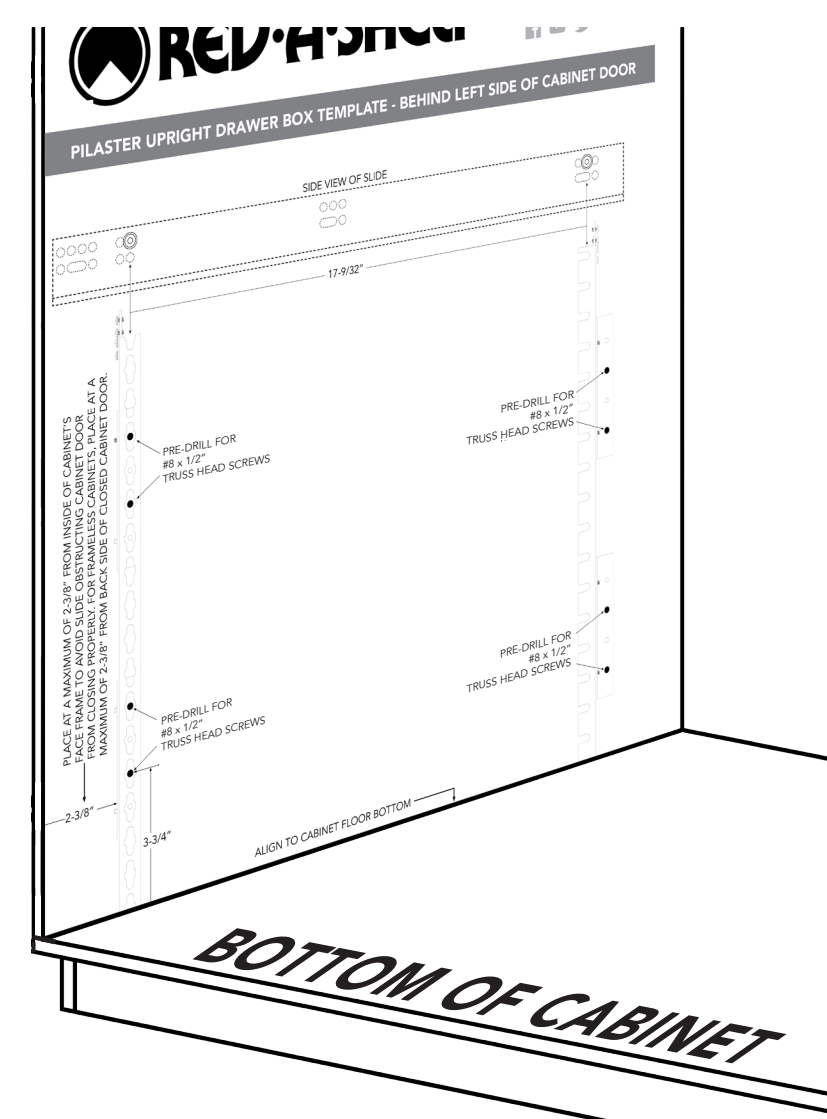

ALIGN TO CABINET FLOOR BOTTOM